

## LOCK NUTS / SHAFT NUTS EXTRACTION NUTS / MOUNTING DEVICES

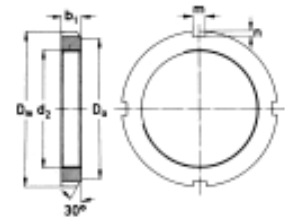
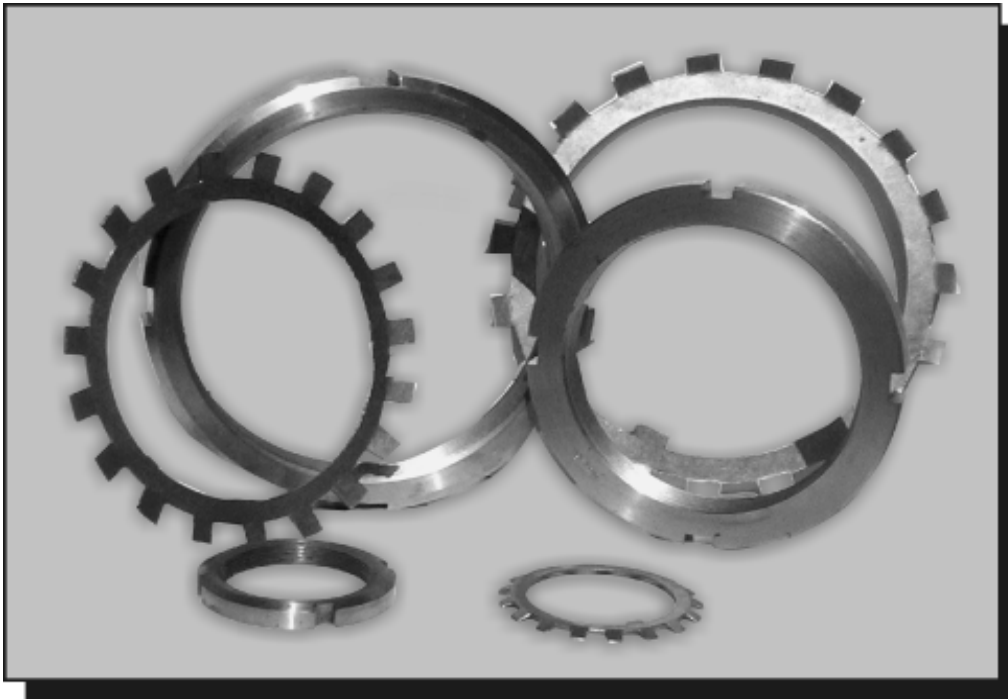

### SERIES

#### KM KML

Shaft Nut / Lock Nut, Extraction Nuts with metric fine threads

Designation	D <sub>m</sub>	b <sub>1</sub>	D <sub>3</sub>	m	n	Thread d <sub>2</sub>	Designation	D <sub>m</sub>	b <sub>1</sub>	D <sub>3</sub>	m	n	Thread d <sub>2</sub>
KM 0	18	4	13.5	3	2	M10 X 0.75	KM 21	140	18	126	12	5	M105 X 2
KM 1	22	4	17	3	2	M 12 X 1	KM 22	145	19	133	12	5	M 110 X 2
KM 2	25	5	21	4	2	M15 X 1	KM 23	150	19	137	12	5	M115 X 2
KM 3	28	5	24	4	2	M17 X 1	KM 24	155	20	138	12	5	M120 X 2
KM 4	32	6	26	4	2	M 20 X 1	KM 25	160	21	148	12	5	M125 X 2
KM 5	38	7	32	5	2	M 25 X 1.5	KM 26	165	21	149	12	5	M 130 X 2
KM 6	45	7	38	5	2	M 30 X 1.5	KM 27	175	22	160	14	6	M 135 X 2
KM 7	52	8	44	5	2	M 35 X 1.5	KM 28	180	22	160	14	6	M 140 X 2
KM 8	58	9	50	6	2.5	M 40 X 1.5	KML 28	165	22	165	12	5	M 140 X 2
KM 9	65	10	56	6	2.5	M 45 X 1.5	KM 29	190	24	171	14	6	M 145 X 2
KM 10	70	11	61	6	2.5	M 50 X 1.5	KM 30	195	24	171	14	6	M 150 X 2
KM 11	75	11	67	7	3	M 55 X 2	KML 30	180	24	170	14	5	M 150 X 2
KM 12	80	11	73	7	3	M 60 X 2	KM 31	200	25	182	16	7	M 155 X 3
KM 13	85	12	79	7	3	M 65 X 2	KM 32	210	25	182	16	7	M 160 X 3
KM 14	92	12	85	8	3.5	M 70 X 2	KML 32	190	25	180	14	5	M 160 X 3
KM 15	98	13	90	8	3.5	M 75 X 2	KM 33	210	26	193	16	7	M 165 X 3
KM 16	105	15	95	8	3.5	M 80 X 2	KM 34	220	26	193	16	7	M 170 X 3
KM 17	110	16	102	8	3.5	M 85 X 2	KML 34	200	26	190	16	5	M 170 X 3
KM 18	120	16	108	10	4	M90 X 2	KM 36	230	27	203	18	8	M 180 X 3
KM 19	125	17	113	10	4	M95 X 2	KM 36	210	27	200	16	5	M 180 X 3
KM 20	130	18	120	10	4	M 100 X 2	KM 38	240	28	214	18	8	M 190 X 3

## LOCK NUTS SHAFT NUTS

### SERIES

#### KM , KML

Shaft Nut / Lock Nut , Extraction Nuts with metric fine threads

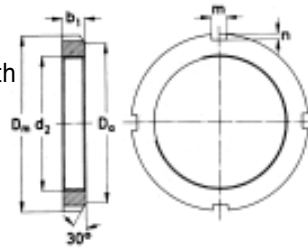

### SERIES

#### HM30, HM31

Shaft Nut with trapezoidal thread.

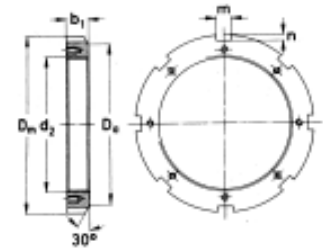

#### HM.. T , HML.. T, HMLL..T

Extraction Nut with trapezoidal thread.

Designation	D <sub>m</sub>	b <sub>1</sub>	D <sub>3</sub>	m	n	Thread d <sub>2</sub>	Designation	D <sub>m</sub>	b <sub>1</sub>	D <sub>3</sub>	m	n	Thread d <sub>2</sub>
KML 38	220	28	210	16	5	M190 X 3	HM 60 T	370	36	340	24	12	Tr 300 X 4
KM 40	250	29	226	18	8	M 200 X 3	HML 60 T	360	31	336	24	12	Tr 300 X 4
KML 40	240	29	222	18	8	M 200 X 3	HM 62 T	380	36	350	24	12	Tr 310 X 5
HML 41T	250	30	232	18	8	Tr 205 X 4	HMLL63T	370	28	350	20	10	Tr 315 X 5
HM 42T	270	30	238	20	10	Tr 210 X 4	HM 64 T	400	40	370	24	12	Tr 320 X 5
HML 43T	260	30	242	20	9	Tr 215 X 4	HML 64 T	380	32	356	24	12	Tr 320 X 5
HM 44T	280	32	250	20	10	Tr 220 X 4	HM 66 T	410	40	380	28	15	Tr 330 X 5
HM 46 T	290	34	260	20	10	Tr 230 X 4	HMLL 67 T	390	28	370	20	10	Tr 335 X 5
HM 48 T	300	34	270	20	10	Tr 240 X 4	HM 68 T	420	42	390	28	15	Tr 340 X 5
HM 50 T	320	35	290	20	10	Tr 250 X 4	HML 69 T	410	33	384	28	13	Tr 345 X 5
HM 52 T	330	35	300	24	12	Tr 260 X 4	HM 70 T	430	42	400	28	15	Tr 350 X 5
HML 52 T	310	30	290	20	10	Tr 260 X 4	HM 72 T	440	45	410	28	15	Tr 360 X 5
HM 54 T	340	36	310	24	12	Tr 270 X 4	HML 73 T	430	35	404	28	13	Tr 365 X 5
HM 56 T	350	36	320	24	12	Tr 280 X 4	HM 74 T	450	45	420	28	15	Tr 370 X 5
HML 56 T	330	30	310	24	10	Tr 280 X 4	HM 76 T	470	45	430	32	18	Tr 380 X 5
HM 58 T	365	36	335	24	12	Tr 290 X 4	HML 77 T	450	37	422	28	14	Tr 385 X 5
HMLL59T	340	27	320	20	10	Tr 295 X 4	HM 80 T	500	46	460	32	18	Tr 400 X 5

### SERIES HM 30 HM 31

Designation	D <sub>m</sub>	b <sub>1</sub>	D <sub>3</sub>	m	n	Hex Bolt	Spring Washer	Thread d <sub>2</sub>
HM 3044	260	30	242	20	9	M 6 X 12	B 6	Tr 220 X 4
HM 3144	280	32	250	20	10			Tr 220 X 4
HM 3048	290	34	270	20	10	M 8 X 18	B 8	Tr 240 X 4
HM 3148	300	34	270	20	10			Tr 240 X 4
HM 3052	310	34	290	20	10	M 8 X 18	B 8	Tr 260 X 4
HM 3152	330	36	300	24	12			Tr 260 X 4
HM 3056	330	38	310	24	10	M 8 X 18	B 8	Tr 280 X 4
HM 3156	350	38	320	24	12			Tr 280 X 4
HM 3060	360	42	336	24	12	M 8 X 18	B 8	Tr 300 X 4
HM 3160	380	40	340	24	12	M 10 X 20	B 10	Tr 300 X 4
HM 3064	380	42	356	24	12	M 8 X 18	B 8	Tr 320 X 4
HM 3164	400	42	360	24	12	M 10 X 20	B 10	Tr 320 X 5
HM 3068	400	45	376	24	12	M 8 X 18	B 8	Tr 340 X 5
HM 3168	440	55	400	28	15	M 12 X 25	B 12	Tr 340 X 5
HM 3072	420	45	394	28	13	M 8 X 18	B 8	Tr 360 X 5
HM 3172	460	58	420	28	15	M 12 X 25	B 12	Tr 360 X 5

## MOUNTING DEVICES

### SERIES KM .. HS

Shaft Nut with metric fine Threads and threaded holes and fitted with mounting screws for easy mounting/dismounting of the bearing

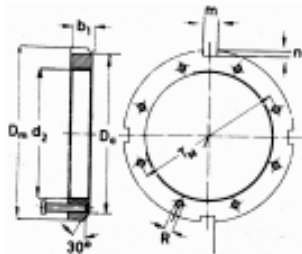

### SERIES HM30..HS, HM31..HS

Shaft Nut ,Extraction Nuts with trapezoidal threads and threaded holes and fitted with mounting screws for easy mounting /dismounting of the bearing

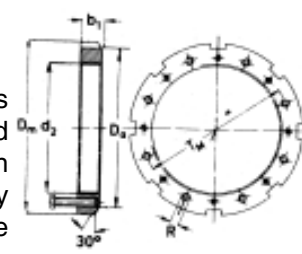

Designation	D <sub>m</sub>	b <sub>1</sub>	D <sub>3</sub>	m	n	R	T <sub>M</sub>	Mounting Screws	Mounting Plate	Thread d <sub>2</sub>
KM 18 HS	120	16	108	10	4	M 6	102	BM 6 X 40		M 90 X 2
KM 19 HS	125	17	113	10	4	M 6	107	BM 6 X 40		M 95 X 2
KM 20 HS	130	18	120	10	4	M 6	112	BM 6 X 40		M 100 X 2
KM 21 HS	140	18	126	12	5	M 6	117	BM 6 X 40		M 105 X 2
KM 22 HS	145	19	133	12	5	M 6	122	BM 6 X 40		M 110 X 2
KM 23 HS	150	19	137	12	5	M 6	127	BM 6 X 40		M 115 X 2
KM 24 HS	155	20	138	12	5	M 8	134	BM 6 X 40		M 120 X 2
KM 25 HS	160	21	148	12	5	M 8	139	BM 8 X 45		M 125 X 2
KM 26 HS	160	21	149	12	5	M 8	144	BM 8 X 45		M 130 X 2
KM 27 HS	175	22	160	12	6	M 8	149	BM 8 X 45		M 135 X 2
KM 28 HS	180	22	160	14	6	M 8	154	BM 8 X 45		M 140 x 2
KM 29 HS	190	24	171	14	6	M 8	159	BM 8 X 45		M 145 X 2
KM 30 HS	195	24	171	17	6	M 10	168	BM10 X 45	MB 30 H	M 150 X 2
KM 31 HS	200	25	182	16	7	M 10	173	BM 10 X 45		M 155 X 3
KM 32 HS	210	25	182	16	7	M 10	173	BM 10 X 45	MB 32 H	M 160 X 3
KM 33 HS	220	26	193	18	7	M 10	178	BM 10 X 45		M 165 X 3
KM 34 HS	230	26	193	16	7	M 10	188	BM 10 X 45	MB 34 H	M 170 X 3
KM 36 HS	240	27	203	18	8	M 10	198	BM 10 X 45	MB 36 H	M 180 X 3
KM 38 HS	250	28	214	18	8	M 10	208	BM 10 X 45	MB 38 H	M 190 X 3
KM 40 HS	250	29	226	18	8	M 10	218	BM 10 X 45	MB 40 H	M 200 X 3
HM 3044 HS	260	30	242	20	9	M 10	236	BM 10 X 45	MB 44 H	Tr 220 X 4
HM 3144 HS	280	32	250	20	10	M 16	246	BM 16 X 60	MB 48 H	Tr 220 X 4
HM 3048 HS	290	34	270	20	10	M 12	260	BM 12 X 60	MB 48 H	Tr 240 X 4
HM 3148 HS	300	34	270	20	10	M 16	266	BM 16 X 60	MB 52 H	Tr 240 X 4
HM 3052 HS	310	34	290	20	10	M 12	280	BM 12 X 60	MB 52 H	Tr 260 X 4
HM 3152 HS	330	36	300	24	12	M 16	286	BM 16 X 60	MB 56 H	Tr 260 X 4
HM 3056 HS	330	38	310	24	12	M 12	300	BM 12 X 60	MB 53 H	Tr 280 X 4
HM 3156 HS	350	38	320	24	12	M 16	306	BM 16 X 60	MB 60 H	Tr 280 X 4
HM 3060 HS	360	42	336	24	12	M 12	322	BM 12 X 60	MB 60 H	Tr 300 X 4
HM 3160 HS	380	40	340	24	12	M 16	330	BM 16 X 60	MB 60 H	Tr 300 X 4
HM 3064 HS	380	42	356	24	12	M 12	342	BM 12 X 60	MB 64 H	Tr 320 X 5
HM 3164 HS	400	42	360	24	12	M 16	350	BM 16 X 60	MB 64 H	Tr 320 X 5
HM 3068 HS	400	45	376	24	12	M 12	362	BM 12 X 70	MB 68 H	Tr 340 X 5
HM 3168 HS	440	55	400	28	15	M 20	374	BM 20 X 80	MB 68 H	Tr 340 X 5
HM 3072 HS	420	45	394	28	13	M 12	382	BM 12 X 70	MB 72 H	Tr 360 X 5
HM 3172 HS	460	58	420	28	15	M 20	394	BM 20 X 80	MB 72 H	Tr 360 X 5
HM 3076 HS	450	48	422	28	14	M 16	406	BM 16 X 70	MB 76 H	Tr 380 X 5
HM 3176 HS	490	60	440	32	18	M 20	416	BM 20 X 80	MB 76 H	Tr 380 X 5
HM 3080 HS	470	52	442	28	14	M 16	426	BM 16 X 70	MB 80 H	Tr 400 X 5
HM 3180 HS	520	62	460	32	18	M 20	436	BM 20 X 80	MB 80 H	Tr 400 X 5