

## WITHDRAWAL SLEEVES

(Without Locknut & Locking Member)

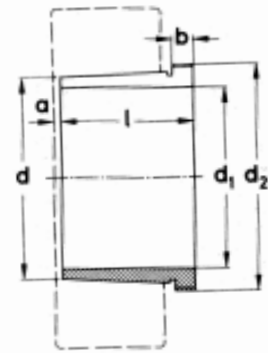

Taper 1 : 12  
Distance a: prior to pressing the sleeve in place

Shaft Diameter mm	Withdrawal Sleeve No.	Dimensions					Extraction Nut	Suitable Bearings to match Sleeve	Approx. Weight kg
		d mm	l mm	a mm	b mm	d <sub>2</sub> Thread			
35	AH 308	40	29	3	6	M 45 X 1.5	KM 9	1308 K 2208 K 2030821308 K 2308 K 22308 K	0.09
	AH 2308	40	40	3	7	M 45 X 1.5	KM 9		0.13
40	AH 309	45	31	3	6	M 50 X 1.5	KM10	1309 K 2209 K 20309 K 21309 K 2309 K 22309 K	0.11
	AH 2309	45	44	3	7	M 50 X 1.5	KM 10		0.16
45	AH 310	50	35	3	7	M 55 X 2	KM 11	1310 K 2210 K 20310 K 21310 K 2310 K 22310 K	0.14
	AH 2310	50	35	3	9	M 55 X 2	KM 11		0.21
50	AHX 311	55	37	3	7	M 60 X 2	KM 12	1311 K 2211 K 2031 K 21312 K 2311 K 22311 K	0.16
	AHX 2311	55	54	3	10	M 60 X 2	KM 12		0.25
55	AH 312	60	40	3	8	M 65 X 2	KM 13	1312 K 2212 K 20313 K21313 K 2313 K 22313 K	0.19
	AH 2312	60	58	3	11	M 65 X 2	KM 13		0.30
60	AH 313	65	42	3	8	M 75 X 2	KM 15	1313 K 2213 K 20313 K 21313 K 2313 K 22313 K	0.25
	AH 2313	65	61	3	12	M 75 X 2	KM 15		0.40
65	AH 314	70	43	4	8	M 80 X 2	KM 16	1314 K 2214 K 20314 K 21314 K 2314 K 22314 K	0.28
	AHX 2314	70	64	4	12	M 80 X 2	KM 16		0.47
70	AH 315	75	45	4	8	M 85 X 2	KM 17	1315 K 2215 K 20315 K 21315 K 1316 K 2216 K 20316 K 21316 K	0.31
	AHX 2315	75	68	4	12	M 85 X 2	KM 17		0.37
75	AH 316	80	48	4	8	M 90 X 2	KM 18	1315 K 2215 K 20315 K 21315 K 2316 K 22316 K	0.31
	AHX 2316	80	71	4	12	M 90 X 2	KM 18		0.60
80	AHX 317	85	52	4	8	M 95 X 2	KM 19	1317 K 2217 K 20317 K 21317 K 2317 K 22317 K	0.37
	AHX 2317	85	74	4	12	M 95 X 2	KM 19		0.67
85	AHX 318	90	53	4	9	M 100 X 2	KM 20	1318 K 2218 K 20318 K 21318 K 23218 K 2318 K 22318 K	0.46
	AHX 3218	90	63	4	10	M 100 X 2	KM 20		0.58
	AHX 2318	90	79	4	14	M 100 X 2	KM 20		0.78
90	AHX 319	95	57	4	10	M 105 X 2	KM 21	1319 K 2219K 20319K 21319 K 2319 K 22319 K	0.53
	AHX 2319	95	85	4	16	M 105 X 2	KM 21		0.89
95	AHX 320	100	59	4	10	M110 X 2	KM 22	1320 K 2220 K 20320 K 21320 K 23120 K 23220 K 2320 K 22320K	0.58
	AHX 3120	100	64	4	11	M 110 X 2	KM 22		0.65
	AHX 3220	100	73	4	11	M 110 X 2	KM 22		0.77
	AHX 2320	100	90	4	16	M 110 X 2	KM 22		1.00
105	AHX 322	110	63	4	12	M 120 X 2	KM 24	20322 K 21322 K 23122 K 22222 K 24122K 30 23222K 22322K	0.66
	AHX 3122	110	68	4	11	M 120X 2	KM 24		0.76
	AH 24122	110	82	9	13	M 115 X 2	KM 23		0.73
	AHX 3222	110	82	4	11	M 125 X 2	KM 25		1.04
	AHX 2322	110	98	4	16	M 125 X 2	KM 25		1.35

## WITHDRAWAL SLEEVES

(Without Locknut & Locking Member)

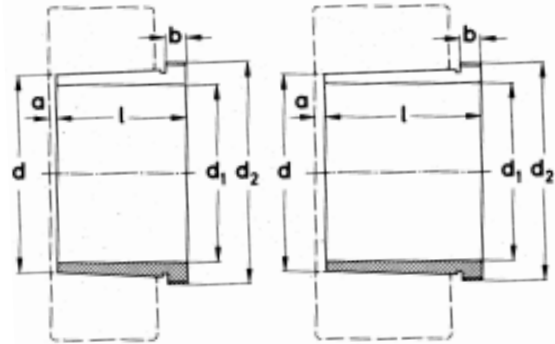

Taper 1 : 12

Taper 1: 30  
( AH240 , AH241)

Distance a : prior to pressing the sleeve in place

Shaft Diameter mm	Withdrawal Sleeve No.	Dimensions					Extraction Nut	Suitable Bearings to match Sleeve	Approx. Weight kg
		d mm	l mm	a mm	b mm	d <sub>2</sub> Thread			
115	AHX 3024	120	60	4	13	M 130 X 2	KM 26	23024 K	0.75
	AH 24024	120	73	9	13	M 125 X 2	KM 25	24024 K 30	0.65
	AHX 3124	120	75	4	12	M 130 X 2	KM 26	23124 K 22224 K	0.95
	AH 24124	120	93	9	13	M 130 X 2	KM 26	24124 K 30	1.00
	AHX 3224	120	90	4	13	M 135 X 2	KM 27	23224 K	1.30
	AHX 2324	120	105	4	17	M 135 X 2	KM 27	22324 K	1.60
125	AHX 3026	130	67	4	14	M 140 X 2	KM 28	23026 K	0.93
	AH 24026	130	83	10	14	M 135 X 2	KM 27	24026 K 30	0.84
	AHX 3126	130	78	4	12	M 140 X 2	KM 28	23126 K 22226 K	1.08
	AH 24126	130	94	10	14	M 140 X 2	KM 28	24126 K 30	1.11
	AHX 3226	130	98	4	15	M 145 X 2	KM 29	23226 K	1.58
	AHX 2326	130	115	4	19	M 145 X 2	KM 29	22326 K	1.97
135	AHX 3028	140	68	5	14	M 150 X 2	KM 30	23028 K	1.01
	AH 24028	140	83	10	14	M 145 X 2	KM 29	24028 K 30	0.91
	AHX 3128	140	83	5	14	M 150 X 2	KM 30	23128 K 22228 K	1.28
	AH 24128	140	99	10	14	M 150 X 2	KM 30	24128 K 30	1.25
	AHX 3228	140	104	5	15	M 155 X 3	KM 31	23228 K 23228 K	1.84
	AHX 2328	140	125	5	20	M 155 X 3	KM 31	222328 K	2.33
145	AHX 3030	150	72	5	15	M 160 X 3	KM 32	23030 K	1.15
	AH 24030	150	90	11	15	M 155 X 3	KM 31	24030 K 30	1.04
	AHX 3130	150	96	5	15	M 165 X 3	KM 33	23130 K 22230 K	1.79
	AHX 24130	150	115	11	15	M 160 X 3	KM 32	24130 K 30	1.56
	AHX 3230	150	114	5	17	M 165 X 3	KM 33	23230 K	2.22
	AHX 2330	150	135	5	24	M 165 X 3	KM 33	22330 K	2.82
150	AH 3032	160	77	5	16	M 170 X 3	KM 34	23032 K	2.06
	AH 24032	160	95	11	15	M 170 X 3	KM 34	23032 K 30	2.33
	AH 3132	160	103	5	16	M 180 X 3	KM 36	23132 K 22232 K	3.21
	AH 24132	160	124	11	15	M 170 X 3	KM 34	24132 K 30	3.00
	AH 3232	160	124	6	20	M 180 X 3	KM 36	23232 K	4.08
	AH 2332	160	140	6	24	M 180 X 3	KM 36	22332 K	4.72
160	AH 3034	170	85	5	17	M 180 X 3	KM 36	23034 K	2.43
	AHX 24034	170	106	11	16	M 180 X 3	KM 36	24034 K 30	2.80
	AH 3134	170	104	5	16	M 190 X 3	KM 38	23134 K 22234 K	0.62
	AH 24134	170	125	11	16	M 180 X 3	KM 36	24134 K 30	3.21
	AH 3234	170	134	6	24	M 190 X 3	KM 38	23234 K	4.80
	AH 2334	170	146	6	24	M 190 X 3	KM 38	22334 K	5.25

Withdrawal Sleeves are without extraction nuts.

Dimension d<sub>1</sub> is equal to Shaft Diameter

## WITHDRAWAL SLEEVES

(Without Locknut & Locking Member)

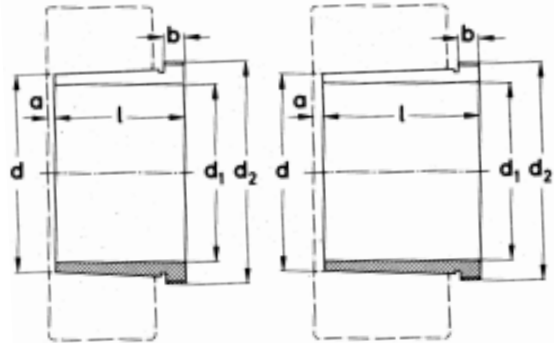

Taper 1 : 12

Taper 1 : 30  
( AH240, AH241)

Distance a : prior to pressing the sleeve in place

Shaft Diameter mm	Withdrawal Sleeve No.	Dimensions					Extraction Nut	Suitable Bearings to match Sleeve	Approx. Weight kg
		d mm	l mm	a mm	b mm	d <sub>2</sub> Thread			
170	AH 3036	180	92	6	17	M190 X 3	KM 38	23036 K	2.81
	AH 24036	180	116	11	16	M 190 X 3	KM 38	24036 K 30	3.10
	AH 3136	180	116	6	19	M 200 X 3	KM 40	23136 K	4.22
	AH 24136	180	134	11	16	M 190 X 3	KM 38	24136 K 30	3.68
	AH 3236	180	140	6	25	M 200 X 3	KM 40	23236 K	5.32
	AH 2336	180	154	6	26	M 200 X 3	KM 40	22336 K	5.83
180	AH 3038	190	96	6	18	Tr 205 X 4	HML 41 T	23038 K	3.32
	AH 24038	190	118	13	18	M 200 X 3	KM 40	24038 K 30	3.50
	AH 3138	190	125	6	20	Tr 210 X 4	KM 42 T	23138 K	4.89
	AH 24138	190	146	13	18	M 200 X 3	KM 40	24138 K 30	4.28
	AH 3238	190	145	7	25	Tr 210 X 4	HM 42 T	23238 K	5.90
	AH 2338	190	160	7	26	Tr 210 X 4	HM 42 T	22338 K	6.63
190	AH 3040	200	102	6	19	Tr 215 x 4	HML 43 T	23040 K	3.80
	AH 24040	200	127	13	18	Tr 210 X 4	HM 42 T	24040 K 30	3.93
	AH 3140	200	134	6	21	Tr 220 X 4	HM 44 T	23140 K	5.49
	AH 24140	200	158	13	18	Tr 210 X 4	HM 42 T	24140 K 30	5.10
	AH 3240	200	153	7	24	Tr 220 X 4	HM 44 T	23240 K	6.68
	AH 2340	200	170	7	30	Tr 220 X 4	HM 44 T	22340 K	7.54
200	AH 3044	220	111	6	20	Tr 235 X 4	HML 47 T	23044 K	7.40
	AH 2244	220	130	6	20	Tr 240 X 4	HM 48 T	22244 K	9.10
	AH 24044H	220	138	14	20	Tr 230 X 4	HM 46 T	24044 K 30	8.25
	AH 3144	220	145	6	23	Tr 240 X 4	HM 48 T	23144 K	10.40
	AH 24144H	220	170	14	20	Tr 230 X 4	HM 46 T	24144 K30	10.20
	AH2344	220	181	8	30	Tr 240 X 4	HM 48 T	23244 K 23344 K	13.50
220	AH 3048	240	116	7	21	Tr 260 X 4	HML 52T	23048 K	8.75
	AH 2248	240	144	6	21	Tr 260 X 4	HM 52 T	22248 K	11.10
	AH 24048H	240	138	15	20	Tr 250 X 4	HM 50 T	240248 K 30	9.00
	AH 3148	240	154	7	25	Tr 260 X 4	HM 52 T	23148 K	12.00
	AH 24148 H	240	180	50	20	Tr 260 X 4	HM 52 T	24148 K	12.50
	AH 2348	240	189	8	30	Tr 260 X 4	HM 52 T	23248 K 22348 K	15.50
240	AH 3052	260	128	7	23	Tr 280 X 4	HML 56T	23052 K	10.70
	AH 2252	260	155	6	23	Tr 290 X 4	HM 58 T	22252 K	14.00
	AH 24052H	260	162	16	22	Tr 270 X 4	HM 54 T	24052 K 30	11.80
	AH 3152	260	172	7	26	Tr 290 X 4	HM 58 T	23152 K	16.20
	AH 24152H	260	202	16	22	Tr 280 X 4	HM 56 T	24152 K 30	15.45
	AH 2352	260	205	8	30	Tr 290 X 4	HM 58 T	23252 K 22352 K	19.60
260	AH 3056	280	131	8	24	Tr 300 X 4	HML 60T	23056 K	12.00
	AH 2256	280	155	8	24	Tr 310 X 5	HML 62T	22256 K	15.20
	AH 24056H	280	162	17	22	Tr 290 X 4	HM 58 T	24056 K 30	12.80
	AH 3156	280	175	8	28	Tr 310 X 5	HM 62 T	23156 K	17.50
	AH 24156H	280	202	17	22	Tr 300 X 4	HM 60 T	24156 K 30	16.30
	AH 2356H	280	212	8	30	Tr 310 X 5	HM 62 T	23256 K	21.60

Withdrawal Sleeves are without extraction nuts . Suffix -H - Withdrawal Sleeves with oil ducts and oil pump connections Refer Page 17

## WITHDRAWAL SLEEVES

(Without Locknut & Locking Member)

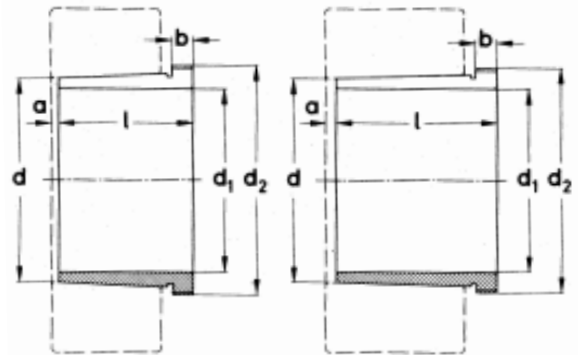

Taper 1 : 12

Taper 1: 30

( AH240, AH241)

Distance a : prior to pressing the sleeve in place

Shaft Diameter mm	Withdrawal Sleeve No.	Dimensions					Extraction Nut	Suitable Bearings to match Sleeve	Approx. Weight kg
		d mm	l mm	a mm	b mm	d <sub>2</sub> Thread			
280	AH 3060	300	145	8	26	Tr 320 X 5	HML 64 T	23060 K	14.40
	AH 2260	300	170	8	26	Tr 330 X 5	HM 66 T	22260 K	18.10
	AH 24060 H	300	184	18	24	Tr 310 X 5	HM 62 T	24060 K 30	15.50
	AH 3160	300	192	8	30	Tr 330 X 5	HM 66 T	23160 K	20.80
	AH 24160 H	300	224	18	24	Tr 320 X 5	HM 64 T	24160 K 30	19.50
	AH 3260	300	228	8	34	Tr 330 X 5	HM 66 T	23260 K	26.00
300	AH 3064 H	320	149	8	27	Tr 345 X 5	HML 69 T	23064 K	16.00
	AH 24064 H	320	184	18	24	Tr 330 X 5	HM 66 T	24064 K 30	16.60
	AH 3164 H	320	209	8	31	Tr 350 X 5	HM 70 T	23164 K	24.50
	AH 24164 H	320	242	18	24	Tr 340 X 5	HM 68 T	24164 K 30	21.50
	AH 3264 H	320	246	8	36	Tr 350 X 5	HM 70 T	23264 K	30.60
	320	AH 3068	340	162	9	28	Tr365 X 5	HML 73 T	23068 K
AH 24068 H		340	206	19	26	Tr360 X 5	HM 72 T	24068 K 30	21.70
AH 3168 H		340	225	9	33	Tr370 X 5	HM 74 T	23168 K	29.00
AH 24168H		340	269	19	26	Tr360 X 5	HM 72 T	24168 K	27.10
AH 3268 H		340	264	9	38	Tr370 X 5	HM 74 T	23268 K	35.40
340		AH 3072 H	360	167	9	30	Tr385 X 5	HM 77 T	23072 K
	AH 3172 H	360	229	9	35	Tr400 X 5	HM 80 T	23172 K	33.00
	AH 24172 H	360	269	20	26	Tr380 X 5	HM 76 T	24172K 30	29.60
	AH 3272 H	360	274	9	40	Tr400 X 5	HM 80 T	23272 K	41.50
360	AH 3076 H	380	170	10	31	Tr410 X 5	HML 82 T	23076 K	23.20
	AH 3176 H	380	232	10	36	Tr420 X 5	HM 84 T	23176 K	35.70
	AH 24176 H	380	271	20	28	Tr400 X 5	HM 80T	24176K 30	31.30
	AH 3276 H	380	284	10	42	Tr420 X 5	HM 84 T	23276 K	45.60
380	AH 3080 H	400	183	10	33	Tr430 X 5	HML 86 T	23080 K	27.30
	AH 3180 H	400	240	10	38	Tr440 X 5	HM 88 T	23180 K	39.50
	AH 3280 H	400	302	10	44	Tr440 X 5	HM 88 T	23280 K	51.70
400	AH 3084 H	420	186	10	34	Tr450 X 5	HML 90 T	23084 K	29.00
	AH 3184 H	420	266	10	40	Tr460 X 5	HM 92 T	23184 K	46.50
	AH 3284 H	420	321	10	46	Tr460 X 5	HM 92 T	23284 K	58.90
420	AH 3088 H	440	194	11	35	Tr470 X 5	HM 94 T	23088 K	32.00
	AH 3188 H	440	270	11	42	Tr480 X 5	HM 96 T	23188 K	49.80
	AH 3288 H	440	330	11	48	Tr480 X 5	HM 96 T	23288 K	63.80
440	AHX 3092 H	460	202	11	37	Tr490 X 5	HML 98 T	23092 K	35.20
	AHX 3192 H	460	285	11	43	Tr510 X 6	HM 102 T	23192 K	57.90
	AHX 3292 H	460	349	11	50	Tr510 X 6	HM 102 T	23292 K	74.50
480	AHX 3096 H	480	205	12	38	Tr520 X 6	HML 104 T	23096 K	39.20
	AHX 3196 H	480	295	12	45	Tr530 X 6	HM 106 T	23196 K	63.10
	AHX 3296 H	480	364	12	52	Tr530 X 6	HM 106 T	23296 K	82.10

Withdrawal Sleeves are without extraction nuts . Suffix -H - Withdrawal Sleeves with oil ducts and oil pump connections Refer Page 17